

Fitting Instructions

VWR Cold Air Intake 2.0 TSI

www.volkswagenracing.co.uk



VWR Cold Air Intake

Installation Guide

Thank you for choosing the VWR Cold Air Intake - developed exclusively by Volkswagen Racing UK for the race programme. This intake and air filter will increase the flow of cold fresh air from outside the car straight to the turbo, and provide a better filtration to the air entering the engine providing you with a more enjoyable performance motoring experience.

We have included instructions on fitting over the next few pages. Please take time to read through, and ensure that your fitting agent reads these. We would suggest that you keep these notes with your car for future maintenance/owners.

Tooling required:

- 1 x Torx T20 socket
- 1 x 7mm Hex socket and ratchet or 7mm hose clip driver
- 2 x 10mm spanners
- 1 x Hose clip pliers
- 1 x 3mm allen key
- 1 x Can of silicone spray

Kit Content:

- 1 ARAB65/78VAG VWR Cone Filter
- 1 STAB99 VWR Airbox
- 1 Silicone Hose 80mm ID x 100mm
- 2 70-90 Stainless Steel Hose Clips
- 1 Intake Duct
- 1 90-110 Stainless Steel Hose Clips
- 1 Rubber Retaining Strap
- 1 M6 x 20 Stainless Steel Cap Head Screw
- 1 M6 Stainless Steel Penny Washer
- 1 M6 Spring Washer

Overview

As a general rule, when fitting the VWR Cold Air Intake system, the following guidelines should be adhered to:

- Air filter kits are of great importance to providing the engine with the cleanest and correct volume of air. They should therefore be fitted with the utmost care and attention.
- It is recommended that they are fitted by persons possessing the necessary expertise i.e. a trained vehicle technician.
- These instructions are for guideline purposes only and do not take into account any special features that may apply.
- Regional and model variances do occur across the vehicles that this part is intended for, which may lead to some minor differences between descriptions and pictures shown in this document. If in doubt please contact your distributor or Volkswagen Racing UK.

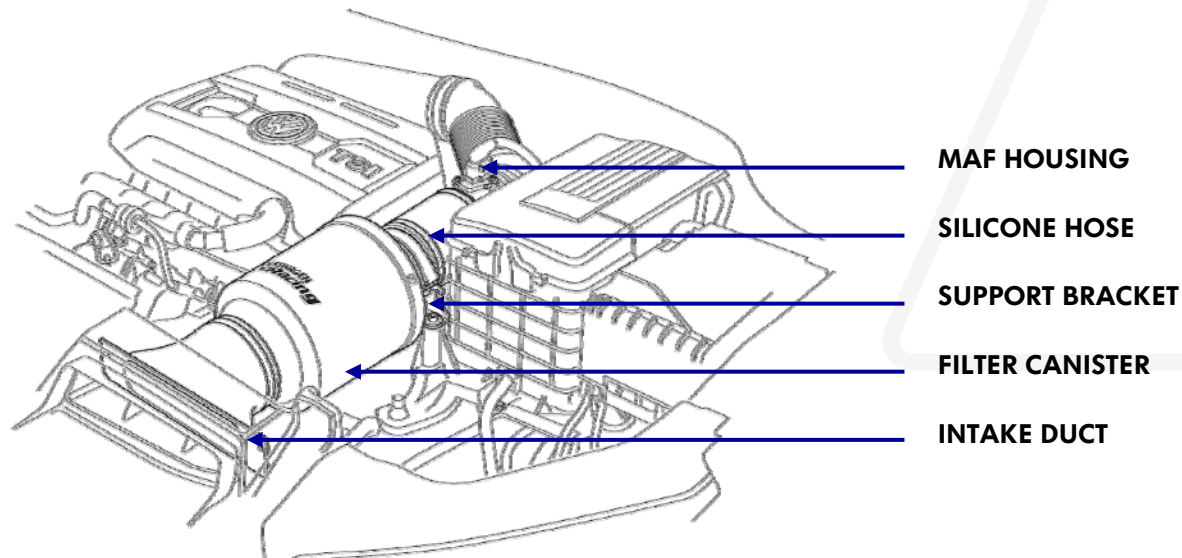

Removal Instructions

The first step in fitting your kit is the removal of the standard airbox, which can be removed pretty much as a complete assembly.

- The first job is to remove the two Phillips head screws that hold the MAF housing in the back of the air filter housing. Both screws and the MAF housing can be removed without disconnecting the plastic pipe, however you may wish to remove the pipe to help gain access.
- With the MAF housing removed from the rear of the airbox you can now undo the single bolt that holds the entire airbox assembly in place, located in front of the battery.
- With the bolt undone, all that is left is to remove the cover from the top of the intake snorkel and then lift the entire airbox.
- Now the airbox is out of the way, remove the remainder of the intake assembly from the radiator mounting panel (slam panel) and you are ready to start installing the new intake.

Fitting Instructions

- The first job to do when installing your new intake is to fit the airbox Support Bracket that fits to the original airbox mounting bracket, making sure you fit the spring washer between the bolt head and penny washer.
- The next task is to fit the intake duct onto the airbox and then drop the airbox into place, sit the filter neck into the support cradle and then tie down the filter and airbox assembly using the rubber strap. Note that If the duct is a tight fit or too tight to fit onto the airbox, gently heat it with a hair dryer/hot air gun or warm it up in hot water until it softens.
- You can now re-fit the two original Torx screws back into the radiator mounting panel (slam panel) to hold the intake duct in place.
- All that is now left is to fit the silicone hose between the MAF housing and the neck of the filter. A light coating of silicone spray inside the hoses makes life a lot easier as you will need to make small adjustments and without the spray the hoses will grip the aluminium pipes very tightly.

All VWR filters come pre-oiled and are ready to use. Please ensure you read the instructions for maintenance in order to keep your VWR Intake System operating in peak performance.

The kit is now fully fitted and ready to use. Before you drive away **DOUBLE CHECK EVERYTHING** one last time!

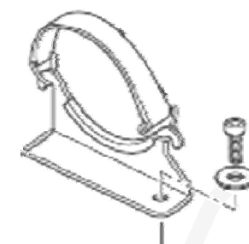

SUPPORT BRACKET,
BOLT AND WASHER

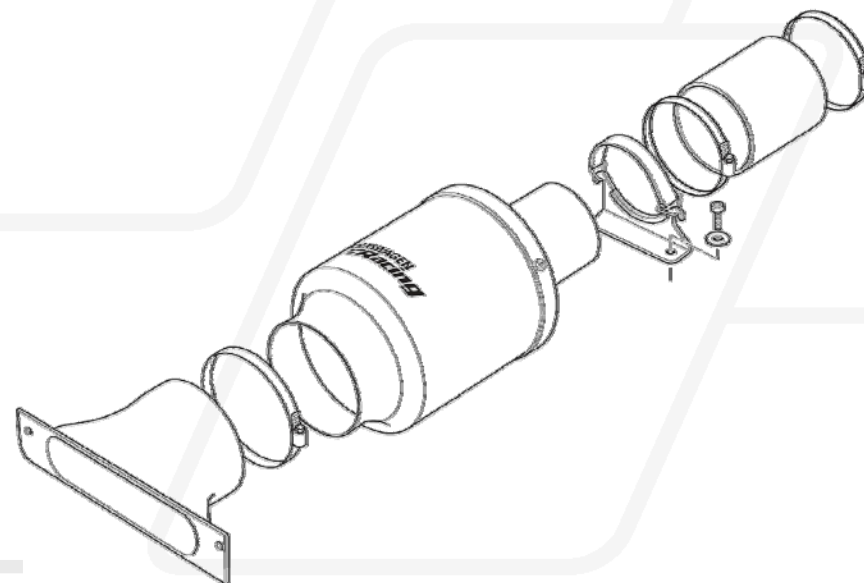

www.volkswagenracing.co.uk

TERMS AND CONDITIONS OF SALE

The VWR RacingLine range of parts are not endorsed for modification of vehicles for use in public highways where warranty or government regulations may be violated. As an express condition of sale of any RacingLine performance part, the buyer acknowledges and agrees to use the performance parts for the modification of vehicles in a manner consistent with any and all local, federal or national regulations and laws, including sanctioned OFF-ROAD competitive events. Emission related aftermarket parts that modify the emission control system may not be legal for sale or use on pollution controlled vehicles. Parts sold by RacingLine are legal only for racing vehicles which may never be used upon a public highway. Performance parts and equipment are sold AS IS without any warranty whatsoever, unless indicated otherwise. There is no warranty implied or stated due to the intended use and purpose of performance parts. While every effort is made to provide technical information and assistance, we have no control over owner installation, modification, and unusual stress that performance parts are subject to. The buyer assumes all responsibility for determining the suitability of the product. The entire risk as to quality and performance parts is assumed by the buyer. In the event such parts proves defective following their purchase and installation, the buyer, not RacingLine, the manufacturer, the distributor, or retailer, assumes the entire cost of any necessary servicing, repair, or replacement. RacingLine will not be responsible for any direct or indirect, actual or incidental expenses attributable to the use of any performance parts, or to delay and inconvenience caused by the necessity of repairing or replacing performance parts.

CONDITIONS OF SALE

Buyers of parts from RacingLine or any authorized distributor are warned that they are sold for off road use only and special warranty provisions apply. Performance parts may exceed the design limits of the vehicle and its subsystems. Suitability and implementation of parts is at the sole discretion of the purchaser. Customer agrees to operate the vehicle under the conditions set forth in this agreement and agrees to hold RacingLine, its employees, agents, and distributors, harmless by reason of any claim, damages, accident, or injuries resulting from the installation of the parts or the use of the vehicle with the installed parts.

OFF-ROAD OR RACING USE

Because Country, state or provincial laws and regulations may prohibit removal or modification of components that were installed on vehicles by their manufacturer to meet motor vehicle safety regulations applicable to vehicles manufactured for use on public roads, RacingLine recommends that vehicles which may fall under these regulations and are equipped with parts designated "for off-road use" not be operated on the public roads, and offers such parts only for track or off-road competitive or performance use only. Performance parts are intended to be used only under controlled conditions, with proper safety equipment and driver's training.

WARRANTY

It is important that you read, understand and comply with the conditions set forth below. RacingLine products have been designed and are intended for off-road applications only. Installation of these products may void the warranty coverage, if any, on your vehicle. Manufacturer vehicle and parts warranties may be voided if the vehicle or part is used for competition or if they fail as a result of modification. RacingLine shall not be responsible should the manufacturer void its warranty by reason of installation of the part or any other modifications occasioned by the installation of said part. However, certain rights are guaranteed a new car owner regarding the manufacturer's warranty. Understanding this, you hereby release and discharge RacingLine, its employees, agents, distributors, and all other persons and associations connected therewith from any and all claims arising out of, or relating to, the parts purchased. You have read and understood the conditions of sale set forth above. You understand that any performance products purchased from RacingLine, and installed implies acceptance of this disclaimer. Any claims on items sold by, but not manufactured by RacingLine should be made with the respective manufacturer.

RacingLine parts are sold with a warranty against defects in materials or workmanship. Abuse or use for purposes other than designed will void the warranty. Implied warranties, including warranties of merchantability or fitness for a particular purpose, are excluded.

RETURNS AND SHIPPING

No cancellation, refunds, exchange, or credit on used parts, modified parts, painted parts, special order parts or custom order parts. No refund, exchange, or credit after seven days. Returns of merchandise, for any reason, are subject to a 20% handling fee.

All shipping charges are not refundable and must be prepaid. All returned items must be in as-new, resellable condition. Any item that has been installed on a vehicle will not be accepted for return under any condition. Please note that certain items such as special order items are non-returnable or refundable. All merchandise is in good condition when leaves our shipping department. If a part is lost (box broken, opened, etc) or damage via transit, you should immediately notify RacingLine).

www.volkswagenracing.co.uk



We hope that your VWR RacingLine Upgrade gives you many years of enjoyable performance motoring.

www.volkswagenracing.co.uk

